



INDIAN INSTITUTE OF MANAGEMENT LUCKNOW

SHORT NOTICE E-TENDER

for

**RENOVATION OF CR1 AND CR 2 CLASSROOM AT
ANUSANDAN BUILDING OF INDIAN INSTITUTE OF
MANAGEMENT LUCKNOW**



**INDIAN INSTITUTE OF MANAGEMENT
LUCKNOW**

Prabandh Nagar, IIM Road
Lucknow-226013

E-TENDER
SHORT NOTICE

**SHORT NOTICE INVITING TENDER FOR RENOVATION OF CR1 AND CR 2
CLASSROOM AT ANUSANDAN BUILDING OF INDIAN INSTITUTE OF
MANAGEMENT LUCKNOW**

To,

M/s

**Sub.: S H O R T N O T I C E inviting E-Tender RENOVATION OF CR1 AND CR 2 CLASSROOM AT
ANUSANDAN BUILDING OF INDIAN INSTITUTE OF MANAGEMENT LUCKNOW.**

This is in reference to the advertisement published on the e-procurement & IIM Lucknow website NIT No.– IIML/PROJ/4476/2025 Date: 28-02-2025 for Renovation of CR1 and CR 2 Classroom at Anusandan Building of Indian Institute of Management, Lucknow, Prabandh Nagar, IIM Road, Lucknow-226013.

Online Percentage Rate E-tenders are invited from Reputed Agencies/ Contractors in a Two-Bid System (i.e. Technical Bid & Financial / Price Bid) for work mentioned above in E-mode from Contractors (Indian Nationals Firms only) and free view NIT is available on Govt. E-Procurement portal i.e. <https://eprocure.gov.in>. The firms are invited, on behalf of the Director, Indian Institute of Management, Lucknow for the above works as per the details attached. The Institute invites you to participate and to send your bids as per the attached SHORT NOTICE inviting E-TENDER.

The price Bid has been prepared on percentage rate items for overall work expenditure. So lowest cost quoted by any Bidder will be **considered as the Lowest Base Rate of the work**. Detailed qualification and work award criteria are stipulated below in this Tender Document.

Interested agencies are requested to sign in only with DSC online (new users may obtain, User-ID, password and Digital Signature). The tender documents comprise of technical bid and a price bid. It is requested to download the Tender on acceptance of terms & conditions. The all documents of this tender, Blank/ unfilled price bid to be Signed stamped, and uploaded in the technical bid. Whereas the Price Bid may be filled in the prescribed M.S. Excel Macros format with Digital signed and uploaded on the E-Portal of Govt. E-Procurement site i.e. <https://eprocure.gov>. by using Digital Signature before the last date & time of submission as mentioned in the tender SHORT NOTICE. The credentials as listed below shall be uploaded online.

Sd/-
Chief Administrative Officer
For Indian Institute of
Management



1.0 Memorandum

Name of work	:	Conversion of the Room Renovation of CR1 and CR 2 Classroom at Anusandan Building of Indian Institute of Management, Lucknow-226013
Earnest Money	:	Rs.96,700/- (Rupees Ninety six thousand seven hundred only).
Tender Fee	:	NIL
Total Estimated Cost	:	Approximately (Inclusive of GST): = Rs.48,32,639/-
Period of Contract	:	90 days from the issue of the LOI.
Date of issue of tender document	:	03.03.2025,
Date Pre-Bid Meeting	:	06.03.2025, 11.00 am
Last Date for submission tender document	:	13.03.2025, 3:30 pm
Date of opening of Technical Bid Opening	:	24 Hrs after the Last date and time of submission
Date of opening of Financial Bid Opening	:	The date for the opening of the financial bid will be intimated to the technically qualified bidders through the e-procurement portal.
Starting of work	:	Within 15 days from the date of the LOI issued.

Participating Tenderers are advised to visit the site before participating in the tendering process to see and clearly understand the Scope of work, Finishing and specifications requirements. Any request later for revising the rates/ scope of work/ specifications etc. on the grounds of misunderstanding by the contractor after the award of the work will not be accepted. The Technical and Financial bids should be uploaded only through the E-tendering process on CPP portal before the due date & time. If there is any query may contact on contact no. 0522-6696100

Sd/-

Chief Administrative Officer
For Indian Institute of Management Lucknow



BRIEF INFORMATION ON SCOPE OF WORK AND TIME LINES.

i. Overview:

- There is a requirement of renovation of 2 nos. Classrooms of IIM Lucknow at its Anusandan Building. The location of the classroom room that required is in PHD Scholar teaching/ library area where the Dean Doctoral Program and other Senior Professors offices are present.
- The size of the room to be renovated is Approx. around 10.00 m x 9.00 m. The room is near to offices and Dean Doctoral Programme office adjacent to it. So Proper precautions while execution are needed to be taken. Any Noise, Dust etc. to be avoided. **At times/ always there may be the requirement that the permission to work in the day is not allowed and the work has to be done during the non-working hours (early morning and late-night hours) and on Holidays so as to complete the work well within the stipulated time. The working Contractor should not claim for the extra time or Financial or any other compensation for working during these odd hours and Holidays.**
- If the contractor fails to complete the work within the stipulated time i.e. within 75 Days from the handing over of the rooms or fails to work as per the quality specification and details or fails to mobilize the manpower and material as per the requirement of the schedule or intentional delays the work by pointing out irrelevant contractual points then the work can be taken over from the contractor on As Is Where Is basis and balance works can be got executed by L2/ L3/ L4 Bidder (if the bidder agrees to work on the L1 rates) as per the decision of the Director. In case any other Bidder does not agree to work on L1 rates then the balance work will be executed at the risk and cost of the working Contractor.
- As mentioned above, the building where work is to be done is already office of various Professors/ PHD students. So the Contractor has to make the proper arrangement for the isolation of the site from public reach and make sure less noise is generated during working hours of the Professors.

ii. Scope of Work:

- Dismantling and removal of all electrical/ Civil fittings, equipment's and fixtures etc. Removal of all fixtures/ fittings, beading, curtain, curtain rods, pedestal Fan, Black Board etc. and any other Audio, video/ electronic/ electric fittings and accessories etc., or any other item as per the instruction of the Engineer-In-charge and safely handing over to the user department with a proper record.
- Safely Covering up the material which cannot be dismantled and properly isolating the site before starting the dismantling work.
- Demolishing the R.C.C./ cement concrete/ Brickwork etc, dismantling/ chase cutting in the floor as per the requirement of the design and properly stacking material at desired location. Disposal of the dismantled material/ Debris/ Malwa/ Rubbish etc. to the desired location as instructed by the Engineer-In-Charge after bifurcating the serviceable and unserviceable items from stack.
- Making of Steps with fly ash Bricks.
- Execution of works such as Concrete, Plaster, Tile Flooring (As per Approved sample), False Ceiling works, False ceiling with W.P.C/ Foam plastic sheet, laminate fixing on the WPC ceiling part, False Wall work, Raised Flooring with fly ash Bricks Chase cutting etc. for laying the wires for charging point and then execution of Tiling on the Raised part, Door mica etc. works and painting etc. works.
- Laying conducting, creation of cable ducts, Pipe/ conduits, race ways etc. on the ceiling/ concealed in walls / concealed in Floor as per the requirement/ as per the Instruction of Engineer In charge.
- Extension/ laying new of the Electrical wiring and modular point, as per the Instruction of Engineer In charge.
- Thoroughly scrapping all the wall paints. Applying putty and acrylic emulsion paint.
- Providing and fixing of the false ceiling at the proper height.



- Providing and fixing of the false ceiling and 12 mm WPC/ Foam plastic sheet ceiling as per the drawings and fixing of the laminates as per the design/ drawings with proper grooves etc. down lighter light with proper wiring and appropriate electrical works, making Cutouts for lights, Projector, A.C. unit, Trap Door etc.
- Supply installation testing and commissioning of the Cassette/VRF Air Condition unit of capacity as per the specifications with proper cabling, piping, Insulation, Drainage piping, Installation and electrical equipment's etc.
- Proper wiring for LAN points, Wi-Fi Access points etc. as per the requirement in the room at the locations directed by the Engineer-In-Charge.
- Installation of UPS and its wiring.
- Providing and fixing of Telephone hand set with appropriate wiring and cabling.
- Providing and fixing of vitrified tiles and skirting.
- Providing, fabricating and fixing of Students table of standard height with plywood of 19mm thick (termite resistant) .
- Providing and fixing wall paper as instructed by the Engineering-In-Charge.
- Providing and fixing of the Roman blinds to the window and other openings.
- Provisions/ Making and installation of motorized Projector lift.
- The Contractor will be required to coordinate with the Audio- Video/ I.T contractor, make provisions in the Ceiling, wall, floor etc. for electric/ LAN/ Audio/ video/ VGA cables etc. as per the requirement of the Audio-Video/ I.T contractor for proper Inter connectivity of Audio – Video, Computer and IT equipment's, mikes, telephone etc. so as to complete the Hybrid Classroom/meeting room in all respect. The contractor must coordinate with the other agency so that no dispute arises in relation to each other works. No claim shall be entertained due to work being executed in the above circumstances. No coordination charges will be paid on this account.
- Qty. in BOQ are estimated and not exact. It is suggested to first check the actual Qtys. of material required as per the actual measurements and then procure the material during the execution as any claim related to the procurement of excess/ less material based on BOQ Qty. will not be considered.

Note: Although I.T/ Audio video part is not in the scope of contractor but LAN wiring, Audio wiring, VGA, Telephone wiring etc. wiring the provisioning for any such wiring by the I.T. contractor such as Race ways/ Trap doors etc. are in the scope of the contractor so as to IT part is also completed as per the design. The contractor will have to coordinate and cooperate with the I.T. contractor.



Eligibility Criteria

a) ANNUAL TURN OVER:

Average annual financial turnover during any Three years from the last 5 financial years in civil/ Interior/

Renovation works, ending 31st March 2022 of the previous financial year, should be at least Rs 100 Lacs. This Condition is Mandatory. The Bidder has to enclose documentary proof clearly indicating Turnover. In case the bidder attaches Chartered Accountant certificate for certifying the Turnover then the Certificate being submitted should be carrying UDIN (Unique Document Identification Number) generated by ICAI (Institute of Chartered Accountants of India)

b) The Bidder should have experience of working with any Government Organization/ PSU/ IIM/ IIT/ NIT/ Any Government Institution. This Condition is Mandatory.

c) The Bidder Should have Experience in execution of Interior/ Renovation works in Any Government/PSU/ Autonomous Body such as IIM, IIT etc. or Should have executed Interior/ Renovation works in any registered Private Limited Organization having Turnover more than 100 Cr in any of the last 5 financial years. As is published by the company in its Annual Financial Report. This Condition is Mandatory.

c) EMD: Earnest Money Deposit as specified in NIT to be furnished in any of the following forms and shall be valid up to 120 days from the last date of submission:

- FDR/ Demand Draft/ Bankers Cheque / Pay Order/ Bank Guarantee payable to-Indian Institute of Management Lucknow, from any Nationalized Bank/ Scheduled Bank payable at Lucknow, & Deposition of EMD through any other form will not be accepted. **The scanned image of earnest money deposit/ MSME certificate (In case the Bidder is taking relaxation in EMD) to be uploaded online along with the Technical bid and the original of EMD deposition proof should reach through speed post or email or courier to the address mentioned below so as to reach Latest by 12:00 Hrs on the last date of submission of tender.** However, the details of DD no. date etc. to be provided in the technical bid. In case needs exemption under MSME criteria then a valid MSME certificate is required to be uploaded on the e-procurement portal.
- Can be deposited in the below-mentioned Institute Bank Account and shared the UTR/ Transaction number and date of Transaction in the Technical bid and the copy of transaction receipt must be uploaded online on the portal with other documents. Those bidders, who are exempted from the deposit of Tender Fee & EMD (Earnest Money Deposit) must submit the relevant certificate to claim the exemption and mention 'Exempted' in the Technical Bid where the UTR number has been asked. In case the enclosed certificate is not valid or not acceptable to the Institute, the submitted bid will be treated as bid without Tender fee/ EMD and will be rejected.

Bank Account No.	07231450000294
IFSC Code	HDFC0000723
Name of Bank & Type of Account	HDFC/Savings

Exemption of MSME for Tender Fee will be as per the format available on CPP portal

This Condition is Mandatory

d) Tender cost (Non Refundable): NIL.

If the Tender Fees is being submitted **in hardcopy**, the same should reach through speed post or courier to the following address up to 12:00 Hrs. on the last date of submission of Tender document as mentioned in Tender NOTICE, failing which tender will not be opened and any postal delay or any other reasons what so ever will not be considered:

To,

The Chief Administrative Officer, Indian

Institute of Management, Prabandh Nagar, IIM

Road Lucknow (U.P.)–226013



Exemption of MSME for Tender Fee will be as per the format available on CPP portal.

This Condition is Mandatory

e) EXPERIENCE:

- (i) Experience of executing the of Interior/ Renovation works with any Central or State Government/ Public Sector/ Autonomous Institution/ Registered Private limited having Turnover more than 100 Cr. As is published by the company in its Annual Financial Report of 23-24/ 22-23/ 21-22/ 20-21/19-20 (Registered means: Definition of Registered private limited company given by Ministry of Corporate Affairs on its website). Experience during last 5 years ending last day of month previous to the one in which tenders are invited should be either of the following.

i. **Three completed contracts of Interior/ Renovation works costing not less than Rs 19.33 Lakhs each.**

OR

ii. **Two completed contracts of Interior/ Renovation works costing not less than Rs 28.99 Lakhs each.**

OR

iii. **One completed contract of Interior/ Renovation works costing not less than Rs 38.66 Lacs each.**

This Condition is Mandatory

Note:

- (1) The work shall be completed as a whole. Partial value/ partial completion is not to be considered.
- (2) The meaning of “Similar Work” for purpose of tender has been defined as “Experience in “of Interior/ Renovation works”.
- f)** Copy of PAN/ GIR No. Registration certificate issued by income tax Authority. This Condition is Mandatory.
- g)** Copy of Certificate of GST number. This Condition is Mandatory
- h)** Constitution & legal status of firm :(Proprietary/ Partnership/ Limited): If the Bidder is Pvt. Ltd. Company then the memorandum of Article and Association and Authorization of the person signing the Bid has to be submitted. This Condition is Mandatory.
- i)** Intending parties are required to submit an undertaking that their firms have never been debarred / blacklisted by any Government/ Public sector department. And there is no criminal case on the Proprietor/ partners/ Any of the Directors in any Police station of any court of India. This undertaking is to be given in the following format:

Undertaking to be furnished by the intending Tenderers: - I/ We declare and

confirm that: -

- i) I/ we have never been blacklisted/ debarred from any Govt./ Public sector enterprises/ Autonomous Body/ IIM Lucknow in minimum last 5 years.
- ii) There is no Arbitration case/ legal case/ dispute of my firm with Indian Institute of Management Lucknow.
- iii) There is no criminal case on me/ and my partner/ board of directors is there in any court/ Police station of India.
- iv) All the information and attachments submitted in the tender document/ envelope are true and correct.
- v) There is no suppression or concealment of information / document with regard to execution of work during the last 05 years.
- vi) I/ We are aware that any false information provided herein will result in the rejection of my tender at any stage.



This Condition is Mandatory

- j) The Bidder is required to submit the Local Correspondence details of his Main/ Branch office at Lucknow so that any Official correspondence required can be done locally through registered post. This Condition is Mandatory.**
- k) The Bidder are also required to inform email address which is regularly checked by the bidder for communications. This Condition is Mandatory**
- l) Registration with IIM/ PWD or other Organization: If any available with the Bidder. This Condition is not Mandatory.**
- m) Valid Registration with Labor Dep't: If Applicable as per the applicable labor law. This Condition is not Mandatory.**
- n) Registration with P.F. and E.S.I. Departments (If applicable). This Condition is not Mandatory.**

Note: a) Condition L is not Mandatory for Technical Qualification.

b) Condition m & n are also not Mandatory for Technical Qualification but the Bidder will have to clearly mention the Applicability/ Non Applicability of these Registrations as per the Govt. Rules. If the Bidder mentions that the Registration Labor/PF/ESI is Applicable, then he must mention the registration no. and attach scanned copy of his Registration. The Bidder will be responsible to cater for all the Applicable Labor Laws, Maintenance of registers etc.as per labor law.

(Signature of contractor)



3.0 INSTRUCTIONS TO TENDERERS

3.1 Indian Institute of Management shall not be bound to accept the lowest tender and reserves the right to reject any or all the Tenders without assigning any reason at any stage of Bidding.

The rates considered in the BOQ are as per DSR 2023 minus 18 % inclusive of GST.

3.2 Tender Documents shall be duly filled & uploaded within the last date of submission as mentioned in the tender NOTICE. Late tenders and conditional tenders shall not be accepted. The last date for receipt of Tender will not be extended under any circumstances, unless otherwise the date is declared a holiday for IIM Lucknow, in which case the next working day will be treated as the last date of receipt of Tender document.

3.3 Financial bid must be filled and submitted in the prescribed formats given on the CPP portal separately. A sample format of the Financial bid has been attached with the Technical bid just for the understanding of the bidders. This is required to be kept blank and just signed and stamped along with the other documents of this Tender. If filled in financial bid is found along with the Technical bid of this Tender, then the Tender shall be straight away rejected.

3.4 Tender must be valid for a minimum period of 120 days from the date of opening. If the Tenderers modifies his tender or revokes the same during this period, the tender may, at the discretion of IIM Authorities, be treated as non – bonafied and cancelled and earnest money will be forfeited.

3.5 This being a **percentage rate contract**, the rate quoted shall remain firm and errors if any in the extension / total shall be subject to corrections. The Estimated quantities/ Amount of Work involved stipulated above/ in the price bid are approximate and hence any reduction / increase thereof during the currency of the contract shall not vitiate the contract. The approximate estimate value of this work is indicated in NIT. This estimate is however no guarantee and is merely given as rough guide. If the work costs more or less, Tenderers will have no claim on that account.

3.6 This is a Percentage Rate Tender. Percentage Rates to be quoted above or below the estimated cost shall be applicable to each and every item rate given in the price bid format. The rate quoted by the tenderer shall be the total sum of material & labor at the IIM Lucknow campus, Lucknow including of GST. The bidders are advised to consider and understand that the percentage rates requested in the BOQ enclosed at price bid of this Tender are inclusive of GST. The rates given against each item in the price Bid are including GST, including all other Taxes/ duties etc. So bidders should carefully quote the percentage rates above or below in the price bid, considering that percentage quoted will be applicable on each and every item Rate of the price bid and any claim to revise any specific item Rate on the basis of any variation in the quantity of such item will not be considered.

The rates given in BOQ are just reference rates and are inclusive of GST component applicable as on date. So whatsoever percentage below or above quoted by bidder shall be inclusive of GST @ 18% as applicable for each and every item. **The reverse calculation of GST component from the overall billed amount will be done while processing the bill.** GST TDS (CGST, SGST) of 2% shall also be deducted from each and every bill of contractor. (please read the BOQ items thoroughly as some requirements as per the site had been added in the item specifications of the BOQ).

In case there is variation occur in GST rates as per Govt. of India i.e if GST variation in rate is above 18% then additional percentage above 18% (Applicable rate% - 18%) shall be paid by the Institute and if GST variation in rate is reduced from 18% then the percentage difference below 18 % (18 % - Applicable Rate) will be recovered from the contractor. The ref rate 18 % is for all items of BOQ Except for Supply of A.C. units which will be as Applicable and accordingly increase/ decrease will be considered as mentioned in the above clause.

3.7 If any discrepancy / misprint is Noticed in specification or BOQ or rates, it should be clarified from the Institute



before quoting the rate.

If any discrepancy in between the price bid format of this Tender document and macros enabled excel file of the actual price bid on CPP portal is observed by the Bidder or if any item unit/ rates are found illogical/ impractical then in that case the same has to be brought to the notice of the Institute before the last date of submission. So that the required correction/ corrigendum can be made. If such issue is found at the later stage after award of the work either by the Contractor or by the Institute, then the logical decision based on the standard practice and as per the Institute's internal documentation shall be taken by the Institute and the same decision will be binding to the contractor and no claim whatsoever will be entertained in this regards

3.8 Following procedures shall be adopted in case of difference in quoted rates in figures and words and extensions:

- a. Where there is difference between rates in figures and the rates, quoted in words shall be considered as correct.
- b. Where the amount of an item is not worked out or it does not correspond to the rate either in figure or in words, the rates quoted in words shall be considered as correct and necessary extension made.
- c. Where the rate quoted by the tenderer in figures and in words tally, but the amount is not worked out correctly, the rates quoted by the tenderer shall be considered as correct and amount shall be corrected accordingly.
- d. In case there is discrepancy in between the unit/ rate/ rates of any/ some items stipulated in Financial bid and sample price bid enclosed with the Technical Bid, the same has to be brought to the Notice of the Engineer in charge and his decision will be final and binding to both the parties.

3.9 The Indian Institute of Management, Lucknow do not bind themselves to accept the lowest or any other tender and reserve the right to accept or reject any or all the tenders either in full or in part without assigning any reason.

3.10 The tender shall be opened & evaluated by the tender opening committee and the successful tenderer shall be informed. Decision of the Tender Opening Committee will be final and binding. Claim by any bidder consider/ reconsider the qualification of his or any other participant bidder after declaration of the Technically Qualified bids will be straightaway rejected.

Further, if it is found that any bidder is intentionally making false claims in order to either to get the award of the work or to get any other participant bidder disqualified then this bidder will be debarred permanently from bidding with IIM Lucknow.

3.11 If a n y of t h e document submitted by the tenderer is found fake, even after the acceptance of tender, the contract will be terminated for which the concerned tenderer will itself be responsible and no compensation, etc., will be paid by the IIM, Lucknow.

3.12 The Director, Indian Institute of Management, Lucknow has reserves the right to reject one or all the tenders without assigning any reason. No claim, whatsoever, shall be entertained on this account.

3.13 5% of the payable bill value of each work will be retained from each bill as defect liability period & shall be released after completion of Defect Liability Period. The Defect liability period will be 12 months except any item of Anti termite treatment and Water proofing work. The Retention money/ Security Deposit deducted above shall be refunded to the contractor after the completion of the stipulated Defect liability period. No interest shall be paid on this retention money/ security deposit.

3.14 This being Percentage Rate contract, the rate quoted shall remain firm and errors if any in the extension / total shall be subject to corrections. The Estimated quantities/ Amount of Work involved stipulated above/ in the price bid are approximate and hence any reduction / increase thereof during the currency of the contract shall not vitiate the contract. The approximate estimate value of this work is indicated in NIT. This estimate and Quantity however are not guarantee and merely given as rough guide, and if the work costs more or less or the Quantities varies to any extent plus or minus, Tenderers will have no claim on that account.

3.15 The tenderer shall not be at liberty to withdraw or modify his tender or any terms and conditions thereof before the expiry of said period. Tenderers are expected to clarify only such points as asked for specifically by the Accepting Officer in writing. Any withdrawal or modification made within the said period constitutes breach of contract and the tenderer shall be liable for damages to the Institute in consequence thereof. He shall in addition forfeit to the Institute, the EMD.

3.16 Any tender which propose any alterations to any of the conditions lay down or proposes any other conditions of any description whatsoever is liable to be rejected.



- 3.17** The EMD shall not carry interest and will be refunded to the tenderers, if the tender is not accepted, unless the same is forfeited to the Institute for any breach on his part. If his tender is accepted, the Earnest Money will be converted into Performance Security Deposit as stipulated.
- 3.18** The drawing (if any) should be returned along with the tender documents with duly signed.
- a) The tender should be accompanied by a certified true copy of the power of attorney of the signatory of the documents.
 - b) Tenderers shall ensure that their tender is up loaded well in advance before the time and date stipulated in the tender notification/documents.
- 3.19** Under no circumstances will a Father and his Son(s) or other close relations who have business dealing with one another be allowed to tender for the same contract as separate competitors. A breach of this condition will render the tender of both parties liable for rejection.
- 3.20** The submission of a tender by a tenderer implies that he has read all the terms and conditions of contract and has made himself aware of the scope and specifications of the work to be done and local conditions and other factor bearing on the execution of the work.
- 3.21** The agencies whose contract were terminated/ are in litigation with IIM Lucknow or are debarred on account of nonperformance in IIM Lucknow's work or have any criminal case in any police station/ court of India will not be eligible for bidding this tender.
- 3.22** Since this is an electronic mode of tendering, any manual or mechanical errors committed before uploading or during the process of uploading the document shall bound to be duly accepted by the Tenderers. The Tenderers shall not have claim whatsoever in this regard.
- 3.23** Tenderers are required to make the DATA ENTRY of the Percentage Rate in figure and rate in words, which will be applicable to all the items stipulated in Price Bid in the prescribed format as given in part B of the Tender (financial bid).
- 3.24** The Tenderers shall download and sign the LETTER OF UNDERTAKING of the document and upload the same along with other documents.
- 3.25** Tenders of those Tenderers who fulfill the criteria mentioned above will only be considered for opening of Price Bid. Tenders received without earnest money/ copy of MSME certificate (for exemption of Earnest Money Deposit) or those which are incomplete or invalid or conditional will be rejected and no correspondence will be entertained in case of rejection.
- 3.26** Contractors / agencies are subject to be disqualified, even though they meet the qualifying criteria, if they make misleading or false representations in the request, statements and attachments submitted in proof of qualification requirements including holding information and or have record of poor performance such as abandoning the works, not properly completing the contract, inordinate delays in completion, litigation history, or financial failures, requesting for claims not admissible under the contract conditions, etc..
- 3.27** All dispute and discrepancies relating to this tender shall be governed by law of India and shall be subject to jurisdiction of court at Lucknow U.P. state.
- 3.28** The Institute reserves the right to accept any tender either in full or in part, to reject all the tenders or distribute the work in more than one agency without assigning any reason. Decision of the Institute in this regard shall be final and binding to the Bidder. The bidder/ bidders in such case cannot claim any compensation for change in the scope / Qty. of work.
- 3.29** These instructions to Tenderers shall be deemed to form an integral part of the contract to be entered for this work.



3.30 GST/ Taxes:

GST or any other tax applicable in respect of inputs procured by the contractor for this contract shall be payable by the Contractor and Institute will not entertain any claim whatsoever in respect of the same.

Rates are inclusive of GST as Applicable.

Contractor and Institute will not entertain any claim whatsoever in respect of the same. Rates are inclusive of GST.

In case there is variation occur in GST rates as per Govt. of India i.e if GST variation in rate is above 18% then additional percentage above 18% (Applicable rate% - 18%) shall be paid by the Institute and if GST variation in rate is reduced from 18% then the percentage difference below 18 % (18 % - Applicable Rate) will be recovered from the contractor. The ref rate 18 % is for all items of BOQ Except for Supply of A.C. units which will be as Applicable and accordingly increase/ decrease will be considered as mentioned in the above clause.

3.31 Where the tender schedule contains special items of work, it will be entirely at the discretion of the Institute to delete these items from the Price Bid and allot these items of work to other Contractors specialized in these works. In such cases, the main Contractor will have to render all necessary co- operation to the other agencies involved so as to ensure smooth progress of all work.

3.32 The Contractors responsibility for this contract shall commence from the date of commencement mentioned in the work order which will be issued by the Engineer-in- Charge after acceptance of work.

3.33 If the tenderer deliberately gives wrong information in his tender or creates conditions favorable for acceptance of his tender, the Accepting Officer reserves the right to reject such tender at any stage, forfeit the EMD, and take Administrative Action against the tenderer like non-issue of tenders etc., as deemed fit by the Accepting Officer.

3.34 At any time, even after award of contract also, if it will be found that the tenderers have deliberately given wrong information or false credentials at the time of tender or at any other time in connection with the contract, IIM, Lucknow reserves the right to reject the offer or cancel the contract. And in such case the contractor/tenderer is liable to forfeit the EMD amount including any other action as deemed fit. The contractor / tenderer is also liable to be permanently debarred for participating in any tender process of IIM, Lucknow concerning to any type of work in future.

3.35 PRECEDENCE FOR ACCEPTANCE:

If any contradiction / variance is observed in different components of the tender, the following precedence shall be observed:

- (i) Site instructions on the Site instruction Book shall precede over the Tender SHORT NOTICE and Instructions to Tenderers.
- (ii) Tender SHORT NOTICE and Instructions to Tenderers shall precede over Special condition.
- (iii) Special Conditions shall precede over General Conditions of Contract.

General Conditions of Contract are available on the IIM Lucknow web site and at the IIML office and shall be the part of the contract. Successful bidder will be required to submit the signed hard copy of the same After issuing of LOI to him before start of work.

In regard to the conditions, specifications, approved makes and mode of measurement not covered above, those contained in DSR 2023/ DAR 2023/ CPWD / Specification shall apply.

However, the Engineer-In-Charge shall be sole deciding authority with regard to the intention of the document and his decision in this respect shall be final and binding on the contractor.

3.36 The tenderer shall not increase their quoted rates in case the Accepting Officer negotiates for reduction in rates, such negotiations shall not amount to cancellation or withdrawal of the original offer and the rates originally quoted shall be binding on the tenderer.

3.37 It is expected the contractor possesses the Delhi Schedule of Rates 2023, DAR 2023, Latest CPWD Specifications, Latest CPWD works manual.



3.38 Rate quoted to include:

- a) Working hours as per office timings, over Time, Late night and early morning working.
- b) Movement of men, material and stacking all as directed by the Engineer-in- Charge.
- c) Removing the items for reuse Such as Amplifier, Projector, Computer, audio and video items, camera, Wall Clock, wall mounted fans, Lights, Curtain rods etc. safely and keeping them in safe custody and reinstalling them at desired location after completion of the work.
- d) Removing of surplus materials and stacking all as directed by the Engineer-in-Charge.

3.39 Before tendering the tenderers are advised to inspect the site of work, sample Class Room at BG II and its environments and be well acquainted with the actual working, restrictions in campus area, security procedures for entry of men and material, prevalent conditions, position of materials and labor, General and Special Conditions of contract, Instructions to Tenderers, drawing (if any) and Specifications, DSR and all other documents which form part of the agreement to be enlisted into.

3.40 In the event of a tender being submitted by a Partnership Firm the tender must be signed separately and legibly by each partner member of the Firm or in their absence a person holding the power of attorney on behalf of the Firm concerned. In the latter case, a copy of the power of attorney duly attested by a Gazette Officer must accompany the tender.

3.41 The successful tenderer shall submit additional Initial Performance security of 3% of Contract Value in case EMD was submitted. The EMD submitted in this case will also be converted to performance security. In case the Exemption has under MSME is given for EMD then 5 % of the contract value has to be submitted as performance security in form of DD/FDR/Bank Guarantee in favor of Director, Indian Institute of Management, Lucknow within 15 days of award of work. A maximum Grace period of 2 Days will be given after levy of penalty equal to 1 % of performance security value per Day. If in case after 17 days of issue of LOI the Performance security is not deposited unless otherwise any extension had been granted by IIM Lucknow then the Work awarded/ LOI issued will be straightaway considered as Terminated.

Similarly Agreement on Rs 100 stamp paper will be required to be executed withing 15 days of issue of LOI and if the contractor fails to get the agreement done within 15 days unless otherwise any extension had been granted by IIM Lucknow then the Work awarded/ LOI issued will be straightaway considered as Terminated.

The performance security (3%+2%) shall be released after 30 Days of satisfactory completion of contract which is 90 days or the extended period of contract whichever is last.

The Chief Administrative Office

For Indian Institute of Management Lucknow



PART-A

(TECHNICAL BID)



TENDER Declaration

I/We have read and examined the NOTICE Inviting Tender, schedule, Specifications applicable, Drawings & Designs, General Rules and Directions, Conditions of Contract, clauses of contract, Special conditions, Schedule of Rate & other documents and rules referred to in the conditions of contract and all other contents in the tender document for the work.

I/We hereby tender for the execution of the work specified for IIM Lucknow within the time specified, viz., schedule of quantities and in accordance in all respects with the specifications, designs, drawings and instructions in writing.

I/ We agree to keep the tendered rates valid till 120 days from the date of opening of tender and not to make any modifications in its terms and conditions.

A sum of Rs. 96,700/- is hereby Deposited at call Receipt of a Scheduled Bank/Fixed deposit receipt of scheduled bank/ demand draft of a scheduled bank/ bank guarantee issued by scheduled bank as earnest money.

OR

I/We had submitted a self-attested copy of valid certificate as a proof of exemption from submission of Earnest money deposit.

If I/we, fail to furnish the prescribed performance guarantee/ execute the Agreement or fail to commence the work within prescribed period, I/we agree that the IIM Lucknow or its successors in office shall without prejudice to any other right or remedy be at liberty to forfeit the said earnest money absolutely. Further, if I/we fail of commence work as specified, I/we agree that IIM, Lucknow or his successors in office shall without prejudice to any other right or remedy available in law, be at liberty to forfeit the said earnest money and the performance guarantee absolutely, otherwise the said earnest money shall be retained by him towards security deposit to execute all the works referred to in the tender documents upon the terms and conditions contained or referred to therein and to carry out such deviations/ additional/ extra items as may be ordered as per the provisions in the Contract.

Further, I/We agree that in case of forfeiture of earnest money or both Earnest Money & Performance Guarantee as aforesaid or non-submission of Performance security and not executing the Agreement within the specified period then I/We shall be debarred for participation in this re- tendering process of the work. In this case the work awarded/ LOI issued to me/ us will be considered as terminated.

I/ we undertake and agree that in case the work is terminated/ rescind by the Institute because of violation of any condition of this tender document and its Annexures/ contract then the Performance security and retention money available with the Institute will be forfeited by the Institute.

I/ We undertake that in such case of termination after award of work/ issue of LOI my/ our firm can be blacklisted for next two years.

That I/ we had read the complete Tender document and understood the scope of work and agree to all the conditions given in this entire Tender document.

I/We undertake and confirm that eligible similar work(s) has/ have not been got executed through another contractor on back-to-back basis. Further that, if such a violation comes to the NOTICE of Department, then I/we shall be debarred for tendering in IIM, Lucknow in future forever. Also, if such a violation comes to the NOTICE of Department before date of start of work, the Engineer-in-Charge shall be free to forfeit the entire amount of Earnest Money Deposit/ Performance Guarantee.

I/We hereby declare that I/we shall treat the tender documents drawings and other records connected with the work as secret/confidential documents and shall not communicate information derived therefrom to any person other than a person to whom I/we am/are authorized to communicate the same or use the information in any manner prejudicial to the safety of the State.

Dated

Signature and Stamp of contractor/ Agency



Postal Address **

**PROFILE AND DETAILS OF
BIDDER**

(Required to be filled by the Bidder either handwritten or typed)

S.no.	Description	Details to be filled by the Bidder.
1.	Name of Firm/ Company	
2.	Name of owner	
3.	Year of Establishment	
4.	Telephone number, Mobile no., Email Address which are in current use.	
5.	Address of the firm (where Registered post can be sent)	
6.	Details of the EMD Deposited or Exemption for MSME Claimed:	
7.	Annual turnover for last 05 years (As per ITR filed). If The C.A. Certificate/ Audit statement is being attached as a proof of Turnover, then the same shall carry UDIN generated by ICAI.	
i	2019-20	
ii	2020-21	
iii	2021-22	
iv	2022-23	
v	2023-24	



8.	Details of Interior/ renovation works with Government/PSU/ Autonomous Body/ Private limited firm (which has achieved than 100 cr. Turnover in any of the last 5 last financial years ending 2023-24 as per the published Annual Financial report of the company)	
	No. of works completed in Five Years with value & Details of works	
i		
ii		
iii		
iv		
v		
10.	Firm/Company registration details of following:	
a	Registration No.	



b	GST Number	
c	Income Tax No. (PAN)	
d	Labour Liscence No.(if Applicable)	
e	P.F. No. (If appicable)	
f	E.S.I. No. (If appicable)	
g	Establishment Details of the company (Proprietary/ Partnership/ Limited)	
11.	Local Address of Correspondence at Lucknow (Where Registered post can be sent)	

Certified that the above information on is correct to the best of my knowledge. Further, my above firm and I/We have not been black listed / Disqualified/ debarred from any of the Government/ Semi Government/ PSUs or Any other agency.

Signature of the Bidder
Name of Bidder & Seal



DOCUMENTS TO BE SUBMITTED WITH TECHNICAL BID

- Duly signed and stamped tender document on each and every page.
- Proof of Payment of EMD: An MSME Certificate /EMD in shape of demand draft/ FDR/ NEFT made to IIML amounting to Rs 96,700/- (Rupees Ninety-six thousand seven hundred Only) drawn in favor of Director Indian Institute of Management Lucknow.

To avail Exemption on EMD as per Govt. norms. Provide that in writing on firm/Vendor letter pad and certificate issued by govt. to avail the exemption like EMD and mention in the above format.

- PAN/ TAN/ GIR
- GST Registration details
- Experience certificates for the works completed in the last five years ending on last Month from the date issue of this Tender Document clearly indicating the value of work, period of execution and satisfactory performance.
- Memorandum of Articles and Association in Case the Bidder is Pvt. Limited company.
- Signatory Authority Letter in case the Bid is signed by person other than proprietor/ partner/ Owner of the firm/ company
- Document to confirm the turnover during last 5 years i.e. 2019-20, 2020-21, 2021-22, 2022-23, 2023-24 along with Income Tax Returns.
- Authorization letter in the name of official submitting the bid, if any.
- Undertaking in the format prescribed above by the bidder that they have not backlisted by any office/ dept. Of Central/ State Government/ PSU/ IIM Lucknow/ and there is no criminal case.

(Signature of the bidder along with seal)

Note: -

- (a) All the documents must be signed by bidder/ authorized signatory.
- (b) Documents must be numbered.
- (c) Documents should be in sequence mentioned above.
- (d) If bidder is registered as MSME and claimed exemption from submission of tender document fee and EMD then relevant and valid document must be submitted.



Mile Stones

S.no.	Mile stones	Period of Completion months from the date of LOI.
a.	Submission of Performance Security	15 Days (without penalty)+ 2 Days (with Levy of penalty @ 1 % of Performance security value per day)
b.	Execution of Agreement	15 Days
	Over all completion period of both Classrooms	90 Days from the date of issue of LO (75 days from Date of handing over of the classrooms)

GENERAL CONDITIONS OF THE CONTRACT

General conditions of the Contract are available at the IIM Lucknow web site and at Project Division Office. These conditions shall be the part of this contract. The successful Bidder shall be required to submit the signed hard copy of these General Terms and Conditions after issue of LOI and before starting of the work.

Special Conditions of the Contract:

4.1 Name of the Work: Conversion of the room (FB-02) in the meeting/ Classroom room at Chintan Building of IIM Lucknow.

4.2 OWNER

Indian Institute of Management, Prabandh Nagar, IIM Road, Lucknow-226013.

4.3 ENGINEER/ENGINEER-IN-CHARGE

Executive Engineer, IIML or any person designated from time to time by owner and shall include those who are expressly authorized by him to act for and on his behalf for operation of this contract.

4.4 SCOPE OF WORK

Detailed description of scope of work has been stipulated in the NIT above.

4.5 CONTRACT RATES

The contract rates are for work to be done in IIM Campus, Lucknow and shall be firm throughout the currency of the contract including the extended period, if any, and shall not be subjected to any escalation due to any reason whatsoever it may be.

Signature of Tenderer



No escalation claim shall be entertained for any statutory increase by the Local Authorities, State/Central Government during the contract period or delay not in the control of the Contractor or delay because of Force Majeure.

The Rates are inclusive of Scaffolding etc. required to work at all Height for every item

The quantities mentioned in the Financial bid are tentative. The rates quoted in tender and as accepted by the owner with or without modification shall hold good for any increase/decrease in quantities. Any of the items may be deleted as per directions of owner/Engineer-in-Charge.

4.6 LEVY/TAXES PAYABLE BY CONTRACTOR

Building and other Construction Workers Welfare Cess or any other tax, levy or Cess in respect of input for or output by this contract shall be payable by the contractor and IIML shall not entertain any claim whatsoever in this respect. The contractor shall deposit royalty and obtain necessary permit for supply of the red bajri, stone, kankar, etc. from local authorities (If Applicable as per the Applicable law of land). If pursuant to or under any law, notification or order any royalty, cess or the like becomes payable by the Institute and does not any time become payable by the contractor to the State Government, Local authorities in respect of any material used by the contractor in the works, then in such a case, it shall be lawful to IIM, Lucknow and it will have the right and be entitled to recover the amount paid in the circumstances as aforesaid from dues of the contractor.

Conditions for reimbursement/ recovery of levy/taxes if levied after receipt of Tenders

All tendered rates shall be inclusive of any tax, levy or cess applicable on last stipulated date of receipt of tender including extension if any. No adjustment i.e. increase or decrease shall be made for any variation in the rate of, Building and Other Construction Workers Welfare Cess or any tax, levy or cess applicable on inputs. **Rates are inclusive of GST as Applicable.**

However, effect of variation in rates of GST or Building and Other Construction Workers Welfare Cess or imposition or repeal of any other tax, levy or cess, applicable on output of the works contract shall be adjusted on either side, increase or decrease. Provided further that

- (i) That such increase including GST shall not be made in the extended period of contract for which the contractor alone is responsible for delay as determined by authority for extension of time.
- (ii) The contractor shall keep necessary books of accounts and other documents for the purpose of this condition as may be necessary and shall allow inspection of the same by a duly authorized representative of the Government and/or the Engineer-in-Charge and shall also furnish such other information/document as the Engineer-in-Charge may require from time to time.
- (iv) The contractor shall, within a period of 30 days of the imposition of any further tax or levy or cess, or variation or repeal of tax or levy or cess/ reduction of such taxes/ cess etc. shall give a written NOTICE thereof to the Engineer-in-charge that the same is given pursuant to this condition, together with all necessary information relating thereto. Decision of the Director of the Institute in this regard to either compensate/ recover the changes in the rates of taxes/ levy of cess etc.

Signature of Tenderer



as the case may be shall be final and binding to the Contractor.

4.7 ESI & PF CODE:

The contractors are required to comply with the provisions of ESI & PF act as per applicability. The contractor shall be required to indemnify IIM for any liabilities arising on account of ESI & PF act.

4.8 The records / registers which Engineer- In- Charge considers necessary for monitoring the works & inspection by chief technical Examiner are to be maintained at site in co-ordination with Engineer-in- Charge and Agency.

4.9 COMMENCEMENT DATE

The date of commencement of work shall be 15 days from the date of issue of the Letter of Intent. The contractor shall have to submit Performance Guarantee as stipulated above within 15 days from the date of issue of Letter of Intent. The work shall be completed within the stipulated time frame. Any work not completed by the contractor/ executed in inferior quality/ unnecessary held up/ disrupted because of any irregularity whatsoever, Engineer In charge/ Competent authority of IIM Lucknow upon serving a 7 days' SHORT NOTICE shall be get work done by other agency at the risk and cost of contractor and the Contractor will have no claim for compensation in this regard.

4.10 VARIATION IN QUANTITIES

Quantities may increase/decrease 100% as per the actual work requirements of Institute. No claim or compensation what so ever shall be entertained in this regard.

4.11 AWARD OF WORK: Work will be awarded to L1 party.

If the contractor fails to complete the work within the stipulated time i.e. within 75 Days from the handing over of the classroom or fails to work as per the quality specification and details or fails to mobilize the manpower and material as per the requirement of the schedule or intentional delays the work by pointing out irrelevant contractual points then the work can be taken over from the contractor on As Is Where Is basis and balance works can be got executed by L2/ L3/ L4 Bidder (if the bidder agrees to work on the L1 rates) as per the decision of the Director. In case any other Bidder does not agree to work on L1 rates then the balance work will be executed at the risk and cost of the working Contractor.

4.12 PERIOD OF CONTRACT

The period of contract shall be 90 days including all holidays, Saturdays & Sundays from the date of L.O.I.

4.13 SITE SUPERVISION

a) Contractor will deploy one Diploma (Civil) Engineer having minimum 2 years' experience of supervision in similar jobs, at site during the actual course of work and having adequate computer skill. C.V. of the Diploma Engineer to be submitted and Approval of CV to be taken from the IIM before actual work starts at site.

b) PENALTY FOR NON-COMPLIANCE OF REQUIRED MANPOWER:

A. Diploma holder with minimum Two years' experience = minimum Rs. 20,000/- per month to the maximum value as decided by the Competent Authority.

Signature of Tenderer



4.14 OFFICE ACCOMODATION FOR CONTRACTOR'S STAFF AND WORKERS:

The Contractors shall at his cost provide, fit up and maintain in an approved portion office accommodation for his representative and Contractors staff and workers. However, suitable area identified as per the decision of the competent Authority will be allocated for the period of contract for the labor colony, Store and Office etc.

4.15 LIQUIDATED DAMAGES

Shall be 1% of the work amount (Calculated as per Tendered rates) per week subject to the maximum of 10% of work value.

4.16 RUNNING ACCOUNT BILL

The contractor shall prepare and submit the running account bills in 2 copies showing item wise quantities executed. The bills shall be submitted within one week from the date of completion of work failing which the bills cannot be considered unless the reasons for delay or non-submission are specified. Measurement of items completed in all respect only will be made.

Bidders have to continue the works uninterrupted as per the schedule during the processing of such bills and payments. Bidders are aware that the Bill processing to payment takes some time so any intentional/ unintentional delay in the work because of delay in the payment will not be accepted and any claim for compensation because of delay in payment will not be entertained.

For processing the final Bill, the contractor has to obtain:

- The User verification certificate for satisfactory completion of the work.
- Submit the necessary manufacturer Test certificates, Guarantee/ warrantee, as built drawings etc.
- Internal inspections/ external inspections/ Third party test/ Other Quality Control reports (if Applicable) especially for the water proofing works etc.

4.17 SECURITY DEPOSIT

a) Performance Security:

The tender should be accompanying Earnest Money as stipulated in Instruction to tenderer. No interest will be payable on Earnest Money.

The E.M.D. of the successful bidder shall be converted to Performance Security Deposit

The successful tenderer shall also submit additional Initial Performance security of 3% of Contract Value (incase EMD had been deposited)/ 5 % (in case exemption for EMD is taken) in form of DD/ FDR/ Bank Guarantee in favor of Director, Indian Institute of Management, Lucknow within 15 days of award of work. Performance security (EMD 2% + 3% of contract value) shall be released 30 days after satisfactory completion of the work.

b) Retention money/ Security Deposit:

Security deposit / Retention money 5% of the certified work value shall be deducted from each Running Account Bill of contractor. The Security deposit/ retention money shall be released 30 days after the satisfactory completion of defects liability period of the work. The Defect liability period will be 12 months except for water proofing works and Anti termite treatment works if any. The Retention money/ Security Deposit

Signature of Tenderer



deducted above shall be refunded to the contractor after the completion of the stipulated Defect liability period except the retention money equivalent to 5 % of cost of the water proofing/ Anti Termite Treatment works if any, which will be released after 10 years of satisfactory completion of the water proofing works. No interest shall be paid on this retention money/ security deposit.

If successful tenderer fails to commence the work within 15 days from the date of issue of Letter of Intent, the Institute may reject the award of work and get the work done by engaging other agency.

4.18 **TESTING OF MATERIALS**

Samples of various materials required for testing shall be provided free of charge by the Contractor. Testing charges if any shall be borne by the contractor. All other expenditure required to be incurred for taking the samples; conveyance, packing etc. shall be borne by the contractor himself.

- a) Regular mandatory test and any additional tests if required, shall be carried out in accordance with the procedure laid down in IS / as directed by Engineer-in-Charge by the contractor at his own cost.
- b) The testing charges, including the cost of materials to be tested and all other incidental charges such as carriage to the testing laboratory etc., shall be borne entirely by the Contractor and the quoted rates shall be deemed to be inclusive of the same.
- c) The Contractor may specifically note that the testing shall be done in Govt. / Govt. (NABL) approved laboratory only.
- d) The Institute may also engage Third Party Quality Assurance (TPQA) Agency. In such case the contractor is required to extend his full cooperation in the testing and inspection as desired by the TPQA.
- e) Any required rectification/ modification/ replacement/ re-execution required in case of defect/ poor quality pointed out by the TPQA/ Engineer in charge has to be done by the contractor at his own cost without any claim for compensation.

4.19 **INSPECTION AND TESTING**

The owner (IIM Lucknow) or his authorized representatives shall have full power to inspect the work or examine the material. Acceptance of any material shall in no way relieve the contractor of his responsibility for meeting the requirements of the specifications. The contractor shall afford and procure for the owner every facility and assistance to carry out such inspection/tests. The cost of any special tests and/or analysis not called for in this specification shall be borne by the contractor.

The Contractor will use Raw materials as approved by Engineer-In-Charge IIM, Lucknow. And shall keep manufacturer Test certificate of the material used (wherever applicable).

All works generally conform to relevant I.S. Code. Any work that do not conform to the Applicable I.S. code shall be redone at the cost of contractors.

The contractor is required to get the work which shall be hidden inspected, measured and photographed by the concerned Engineer/ officer before covering it up. The contractor has to keep the photographs of works being executed including the pics of steps involved in the execution of the works. In case certain quality check is

Signature of Tenderer



required in these steps involved then the contractor should get it done.

4.20 LABOUR CAMP

The contractors at his own risk and cost shall establish the Labour Camps (as per labour welfare and safety norms) outside the site premises as per the area allocated by the Institute. Contractor will have to make his own arrangement for staying/ accommodation for his manpower if staying outside the complex. Nothing extra shall be payable on this account.

4.21 Security Procedure:

For Security reasons the Contractor has to provide the details of Labour who will work such as Labor Name, Their photo Identity details along with the copy of each ID etc.to the engineer in charge. Copy of these documents will be submitted to Assistant Commandant Security at the main Gate. The Contractor has to follow the Institute's SOP as is maintained at the main gate for the entry and exit of any material, manpower, machinery etc.

4.22 SAMPLES

The Contractor has to get Approved the Sample of Tiles, False ceiling, fixtures, light, fan, Switches, Laminate, Foam plastic/WPC Boards, Paint, Carpenter and other Hardware fittings, wooden flooring and other finishing items before providing and fixing of these materials in the Rooms. The contractor may deliberate to provide such samples for Approval within 10 days of issue of LOI.

It shall be the responsibility of the contractor to submit samples of raw material to be used in the execution of the awarded work and any other items as decided by the owner. One such approved sample each shall be kept with the owner and at site for future reference.

Test Samples of raw material (if required) as per the Instruction of the Engineer In charge will be prepared by the contractors and same to be tested as per code of practice at the cost of contractor as directed by Engineer-In-Charge.

4.23 SUB-STANDARD MATERIALS

Any material rejected by the owner shall be removed from the site within 48 hours of issue of instructions to this effect by the owner. Failing this, the owner shall have to rights to get these removed at the cost of the contractor and the contractor shall have no claim whatsoever in this regard.

4.24 SPECIFICATION

Contractor shall perform work in accordance with the latest CPWD Specifications, as per the specification of material mentioned and as per the direction of the Engineer in charge.

Only the material of Approved make and manufacturer shall be used as is stipulated at the end of this Technical Bid.

4.25 DEFECT LIABILITY PERIOD

Twelve months from the virtual date of completion of work and removal of hutments, materials, etc. from site except for Water proofing and Anti Termite Treatment works (if Applicable) which is 10 years.

4.26 CORRESPONDENCE

All correspondence shall be addressed to:

The Chief Administrative Office
Indian Institute of Management
Prabandh Nagar, IIM Road,
Lucknow – 226013 (U.P.)

Signature of Tenderer



4.27 **JURISDICTION**

The contract will be subject to the territorial jurisdiction of Courts in Lucknow alone.

- 4.28 The contractor shall indemnify and keep indemnified Indian Institute of Management, Lucknow against payments to be made under and for the observance of the laws aforesaid and the C.P.W.D. Contractor's Labour Regulations without prejudice to his right to claim indemnity from his sub- contractors.

4.29 **RULES FOR SAFETY AND LABOUR WELFARE**

The Contractor shall comply with the safety and Labour Welfare Rules, as given hereunder and as per the Rules and Regulations framed by Local Authorities/ Statutory Bodies/ State/ Central Govt. from time to time.

4.30 **SAFETY PRECAUTIONS**

Safe means of access shall be provided to all working platforms and other working places. Every ladder shall be securely fixed. Adequate precautions shall be taken to prevent danger from electrical equipment. No materials on any of the sites shall be so stocked or placed as to cause danger or inconvenience to any person of the public. The Contractor shall provide all necessary fencing and lights to protect public from accidents and shall be bound to bear expenses of defense of every suit, action or other proceedings at law that may be brought by any person for injury sustained owing to neglect of the above precautions and to pay any damage and costs which may with the consent of the Contractor be paid to compromise any claim by any such person. All workers should wear Safety helmet, Safety Shoes, Fluorescent jacket and Safety Belt (If required) during the execution of the work.

NOTE: All scaffolds, ladders, First Aid Equipment's/ Machines and other safety devices mentioned or described herein shall be maintained in a safe condition and no scaffold, ladder or equipment shall be altered or removed while it is in use. Adequate washing facilities shall be provided at or near places of work. Necessary warning sign boards in Red/White paint, with proper lighting arrangements for nights are to be provided by the Contractor at his cost, as approved by the Engineer-in-Charge at prominent locations. The arrangements for providing and maintaining all such safety and labour welfare measures, Registers etc., shall be done at the Contractor's own cost and expenses.

4.31 **DISPUTE & ARBITRATION**

All disputes or differences whatsoever arising between the parties out of or relating to the construction, meaning and operation or effect of this contract or subject thereof or the breach thereof that cannot be settled by good faith and negotiations between the parties within 30 days of the commencement of negotiations may be settled by referring the dispute to the Director, IIM Lucknow, who may appoint an Arbitrator who is unconnected with IIM to adjudicate the same. The proceedings will be governed by the provisions of the Arbitration & Conciliations Act, 1996. The place of arbitral proceedings will be Lucknow.

- 5.1 **Advance:** No mobilization advance will be paid to the contractor.

- 5.2 **Escalation:** No cost escalation shall be paid in any case because of increase of the cost of raw material or delay in the work because of any reason.

- 5.3 **Altered/ Additional/ substituted work:** If the altered/additional or substituted work or any additional work required to be as per Institute's requirement shall be carried out by the contractor on the same conditions in all respects including price on which he agreed to do the main work except as hereafter provided for which there are no established rates in schedule of items and Delhi Schedule of rates., the same shall be payable as per the

Signature of Tenderer



provision stated hereunder.

- a) If any extra item crops up during the work (Other than that given in the Work Order), the rate for such item shall be computed as per rates of CPWD/DSR-2023 with the same percentage above or below as is quoted by the Contractor in the Price Bid).
- b) Rates for items where rate is not available in DSR-2023 shall be derived from the similar item of nearest DSR. If not available in the nearest DSR then in the nearest District Schedule of Rates issued by the Uttar Pradesh PWD department. If the item is not found in DSR and District Schedule of rates, then the Percentage Rate from nearest available Schedule of rates of any Central/ Uttar Pradesh Government Department Shall be considered with whatever applicable Cost index plus or minus (If any as per relevant Circular from the department) on the schedule of rates considered.
- c) If direct working out is not possible as mentioned in a) & b) above, the contractor shall be paid on the basis of actual cost of material and labor plus cartage, T & P etc. cost plus 15% towards profit, supervision, overheads establishment etc. and applicable taxes as decided by the Competent Authority.
- d) In the case of substituted items (items that are taken up with partial substitution or in lieu of items of work in the contract), the rate for the agreement item (to be substituted) and substituted item shall also be determined in the manner as mentioned in the following para:
 - (i) If the market rate for the substituted item so determined is more than the market rate of the agreement item (to be substituted), the rate payable to the Contractor for the substituted item shall be the rate for the agreement item (to be substituted) so increased to the extent of the difference between the market rates of substituted item and the agreement item (to be substituted).
 - (ii) If the market rate for the substituted item so determined is less than the market rate of the agreement item (to be substituted), the rate payable to the contractor for the substituted item shall be the rate for the agreement item (to be substituted) so decreased to the extent of the difference between the market rates of substituted item and the agreement item (to be substituted).

5.7 Where the work is found substandard the contractor shall be liable to rectify them to the satisfaction of Engineer-in-Charge by either rectifying or replacing.

5.8a For Site: The Institute will provide free water and electricity for the work from existing point only for site works. The material such as for the Necessary loose pipes and electric wire and plug, sockets etc., to be arranged by contractor themselves on their cost.

5.8b For Labor Hutment: Institute will facilitate the contractor with the required documents in obtaining the Electricity connection from the electricity department for his labor colony. In case the institute provides electric connection on actual chargeable basis for the hutment then the required material such as cable, changeover, Energy Meter etc. required to provide the connection shall be arranged and provided by the contractor. Water Supply for the labor colony has to be arranged by the Contractor himself.

5.10 In case Institute is not satisfied with the performance of contractor, the Institute is empowered to get the work completed by other agency and debit the expenditure, risk and cost on contractor's account. No objection or

Signature of Tenderer



claim, what so ever on this account will be entertained.

5.12 Maintaining of records has to be made by contractor as per direction of Engineer-in-Charge.

5.13 The generated Debris or wastage at work site have to be cleared by the contractor on same day from the work site and thrown out the site campus or designated place as per guidance of Engineer-in- Charge.

Specifications for Cassette Type Hot and cold A.C.

S.no.	Particulars	Specifications
1	Rated Cooling Capacity	5 HP
	Rated Cooling Capacity (100% load) BTU/HR	48000
2	Power Source	1Phase/3 Phase/50Hz
3	Refrigerant Charge	R410A
4	Sound pressure level (Cooling/Heating)	max 55 dB
5	Ambient Temperature (deegree celcius)	-5 to +52
6	Referigent piping size (Liquid Line)	as per OEM
7	Referigent piping size (Gas Line)	as per OEM
8	Thickness of the Cooper piping	not less than 1.2mm
9	Number of connectable indoor units	01 or more
10	COP (Coefficient of Peformance)	Above 3.1
11	Compressor Type	Rotary/Scroll Type
12	Fan Speed (No. of steps)	4
13	Air Flow (IDU) (Cooling Super High) CFm (High)	1100
14	Fresh Air Intake Provision	Yes
15	Sleep and Time Control	Yes
16	On/Off Timer with Advance Startup	Yes
17	Dry Mode	Yes
18	Safety Devices	High Pressure switch, Fan Driver overload Protector, over current relay, Inverter overload protector, Over/Under Voltage protector PCB
19	Rated Power Supply	
	For Single Phase	220 +/- 10 %, 50 Hz
	For 3 Phase Voltage and Frequency	415 +/- 10 %/, 50 Hz
20	Remocon Type	LCD Cordless

Note: Contractor will be required to submit the Specifications of Make and Model being offered and get it Approved before Procuring the A.C.

Signature of Tenderer



List of Approved Makes

Sl. No.	Item Description		Approved Brands / Manufacturers
A.	FLOORING		
	1	Vitrified Tiles	Nitco/ Kajaria or Equivalent.
	2	Ceramic Tiles	Nitco/ Kajaria or Equivalent.
	3	Tile Adhesive	JK super grip/ Engineer plus/ Ultratech/ pidilite (Roff)/ Kerokoll/litigrate/ saint gobain (weler)/ As Aproved.
	4	Brick Masonry	Class 1 Bricks only
B.	PLY / BOARDS / LAMINATES / VENEERS		
	1	Commercial Ply wood	Conforming to IS 303 approved Green Ply / Kitply - 12mm/ 6 mm
	2	Boiling Water Proof Block Board.	Conforming to I.S. 1659, Green ply/ Kitply/ Century/ Samrat Plywood Limited/ SRG Ply & Boards/ National Plywood Industries Limited/ Archid Ply/ As approved.
	3	Veneers (3 to 4mm and paper veneers)	Greenlam/ Merino/ Equivalent As Approved.
	4	Laminate 0.8, 1mm & 1.5mm	Greenlam/ Merino/ Equivalent as Approved
	5	Foam Plastic board/ WPC Board	Astion Tesa/ poly green/ plasto green/ Equivalent As Approved.
	6	Wood Preservative	Termiseal
	7	Mirror/ Glass	Saint Gobain/ Modi Guard
C.	CIVIL		
	1	Cement (PPC)	ACC / Ultra Tech / Birla Samrat/ JK
	2	Adhesives	Pidilite
	3	Light Weight Concrete Blocks	Siporex
	4	Waterproofing Compounds	Pidilite (Dr. Fixit)/ Fosroc / Sika
	5	Pest Control Chemical	PCI/ Godrej

Signature of Tenderer



	6	White Cement	Birla White/ JK White
	7	Wall Putty	JK/Birla/Tata/ Asian
	8	Galvanized/ Stainless Steel Anchor fastners	Shakti/ Arrow/ Hilti/ Fissure.
	9	Dash Fastner, Expansion Bolts	Hilti/ Fissures/ Dev Ashish
D	BLINDS		
	1	Vertical Blinds	Vista/Mac/Hunter Douglas/LIVIN or as Approved
E	PAINTS		
	1	Primer	Asian/ Berger/ Nerolac/ Dulux
	2	Lustre/Enamel Paint	Asian/ Berger/ Nerolac/ Dulux
	3	Luxury Emulsion with Teflon surface protector, Water beading technology, Antimicrobial, Flame spread resistance paint with 5 years warranty.	Asian Paint/ Equivalent As Approved
F	FALSE CEILING		
	1	Gypsum Board False Ceiling (Moisture and Fire Resistant)	Saint Gobain (Gyproc) / Armstrong.
	2	Calcium Silicate Grid Ceiling	Saint Gobain (Gyproc)/ Armstrong -
	3	Grid Channel/ Tee/ Angle/Flat etc.	Saint Gobain (Gypframe)/ Armstrong -
G	MISCELLANEOUS		
	1	Door Closer	Dorma/ DORSET/OZONE
	2	Insulation material	Nitrile rubber
	3	Aluminum Sections	Jindal/Hindalco
	4	Sun Protective Films	3M
	5	Door Hardware	Dorma / Geze/ Godrej
	6	Cabinet, Wardrobe, Drawer Hardwares and Fittings	Haffle/ Dormakaba/ Dorset/ Hettich/ ozone/ Ebco/ Godrej/ Equivalent as Approved
	7	Door Lock	Dormakaba/ Godrej/ equivalent as Approved.
H	ELECTRICAL		
	1	Isolators, Change Over switches	Havells
			BCH
			Siemens
			Schneider
			ABB

Signature of Tenderer



			Equivalent as Approved.
	2	BLDC Fan and Exhaust Fan and Wall mounted fans	Atom berg
			Crompton
			Havell's
			Bajaj
			Usha
			Equivalent as Approved.
	3	Cables	
	4	Instrumentation	CII
			NICCO
			Asian (RPG)
			Polycab
			Lapp Kabel
			Universal
			RR Kabel
			Equivalent as Approved.
	5	House Wiring	Polycab
			Finolex, Havell's
			KEI
			Equivalent as Approved.
	7	Lighting systems	Philips/ Wipro/Anchor/ Havell's/ Bajaj/ Crab Tree/ Equivalent as Approved.
	8	Modular switches for commercial / residential installations	ABB/Legrand/Anchor Roma/Havell's/ Equivalent as Approved.
	9	Terminals	Elmex/ Wago/ Phoenix/ Equivalent as Approved.
	10	Conduits and accessories	Lapp Kabel/ BEC/ AKG/ Steel craft/ Equivalent as Approved.
	11	Cable lugs	Dowells/ Jainson/ Equivalent as Approved.
	12	Cable glands	Baliga/ comet/ SMI/ Equivalent as Approved.
	13	Luminaries	Philips/ Jaquar/ Havell's/ Bajaj/ Anchor/ Equivalent as Approved.
	14	DATA Cables	Tyco / AMP/ Equivalent as Approved.
	15	Call Bell	Anchor/ Havell's/ Equivalent as Approved.

Signature of Tenderer



PART- B

(FINANCIAL BID)



FINANCIAL BID

RENOVATION OF CR1 AND CR 2 CLASSROOM AT ANUSANDAN BUILDING OF INDIAN INSTITUTE OF MANAGEMENT LUCKNOW

Rates are Inclusive of GST

NOTICE INVITING TENDER FOR RENOVATION OF CR1 AND CR 2 CLASSROOM AT ANUSANDAN BUILDING OF INDIAN INSTITUTE OF MANAGEMENT LUCKNOW

Note: All the Rates are Inclusive of GST as Applicable

Sl. No.	Item Description	Quantity	Units	Estimated Rate in Rs. P	TOTAL AMOUNT Without Taxes in Rs. P
1	Cutting chases in brick masonry walls and concrete/ Mosaic floor for pipes/conduits/ raceways etc. for wiring works and networking/ Audio- video etc. works as per the drawing/design/ instructions of Engineer Incharge and making good the same with cement concrete 1:3:6 (1 cement : 3 coarse sand :6 graded stone aggregate 12.5 mm nominal size), including necessary plaster and pointing in cement mortar 1:4 (1 cement : 4 coarse sand) :				
2	for upto 50 mm dia pipes/ conduits/ raceways etc.	40	RMT	275.52	11020.8
3	50 to 75 mm dia pipes/ conduits/ raceways etc.	40	RMT	420.87	16834.8
4	75 to 100 mm and above upto 200 mm	40	RMT	584.82	23392.8
5	Dismantling tile work in floors and roofs laid in cement mortar including stacking material within 50 metres lead. For thickness of tiles above 25 mm and up to 40 mm sqm	167	SQM	92.95	15522.65

Signature of Tenderer



6	Demolishing cement concrete manually/ by mechanical means including disposal of material within 50 metres lead as per direction of Engineer - in - charge. Nominal concrete 1:4:8 or leaner mix (i/c equivalent design mix)	1	CUM	1232.95	1232.95
7	Disposal of building rubbish / malba / similar unserviceable, dismantled or waste materials by mechanical means, including loading,transporting, unloading to approved municipal dumping ground or as approved by Engineer-in-charge, beyond 50 m initial lead, for all leads including all lifts involved. Disposing the material to the location decided by the Engineer Incharge systematically as instructed.	4	CUM	216.44	865.76
8	Repairs to plaster of thickness 12 mm to 20 mm in patches of area 2.5 sq.meters and under, including cutting the patch in proper shape,raking out joints and preparing and plastering the surface of the walls complete, including disposal of rubbish to the dumping ground, all complete as per direction of Engineer-in-Charge. Wall & Ceiling.	36.000	SQM	448.87	16159.32
9	Removing dry or oil bound distemper, water proofing cement paint and the like by scrapping, sand papering and preparing the surfaces smooth including necessary repairs to scratches etc. complete. Wall & Ceiling	68	SQM	20.62	1402.16
10	Providing and applying white cement based putty of average thickness 1 mm, of approved brand and manufacturer, over the plastered wall surface to prepare the surface even and smooth complete.	167	SQM	127.96	21369.32
11	Finishing with Deluxe Multi surface paint system for interiors and exteriors using Primer as per manufacturers specifications :Two or more coats applied on walls and ceiling @ 1.25 ltr/10 sqm over and including one coat of Special primer applied @ 0.75 ltr /10 sqm (Asian paints Aspira or equivalent in other brands)	100	SQM	158.83	15883
12	Brick work with non modular fly ash bricks conforming to IS:12894, class designation 10 average compressive strength in super structure above plinth level up to floor V level in :				0
13	Cement mortar 1:6 (1 cement: 6 Coarse sand)	74	CUM	7177.09	531104.66
14	Providing and laying in position cement concrete of specified grade excluding the cost of centering and shuttering - All work up to plinth level : 1:2:4 (1 Cement: 2 coarse sand (zone-III) derived from natural sources: 4 graded stone aggregate 40 mm nominal size derived from natural sources).	1.8	CUM	6379.85	11483.73

Signature of Tenderer



15	Providing and fixing, in position concealed G.I. section for wall paneling using board of required thickness fixed on the 'W' profile (0.55 mmthick) having a knurled web of 51.55 mm and two flanges of 26 mm each with lips of 10.55 mm, placed @ 610 mm C/C in perimeter channel having one flange of 20 mm and another flange of 30 mm with thickness of 0.55 mm and web of length 27 mm. Perimeter channel is fixed on the floor and the ceiling with the nylon sleeves @ 610 mm C/C with fully threaded self-tapping dry wall screws. Board is fixed to the 'W' profile with 25 mm countersunk ribbed head screws @ 200 mm C/C., all complete as per the drawing & directions of engineer-in-charge, the joints of the boards are finished with specially formulated jointing compound and 48 mm wide jointing tape to provide seamless finish. Tapered edge calcium silicate board made with calcareous & siliceous materials reinforced with cellulose fiber manufactured through autoclaving process to give stable crystalline structure with compressive strength 225 kg/ sq.cm, Bending strength 100 kg/sq.cm. 10mm thick	30	SQM	1468.58	44057.4
16	Thermal Insulation of roofing/ wall with Expanded polystyrene fixed with suitable adhesive to the false wall in between the frames of false wall as per the directions of the Engineer-in-charge: With Type SE - Self Extinguishing type 50 mm thick sqm	30.000	SQM	289.50	8685
17	Providing and fixing factory made single extruded WPC (Wood Polymer Composite) solid plain white color board for backing of cup boards and bathroom/kitchen cabinets etc. of required size comprising of virgin polymer of K value 58-60 (Suspension Grade), calcium carbonate and natural fibers (wood powder/ rice husk/wheat husk) and non toxic additives (maximum toxicity index of 12 for 100 gms) having minimum density of 650 kg/cum and screw withdrawal strength of 1800 N (Face) & 900 N (Edge), minimum compressive strength 50 N/mm ² , modulus of elasticity 850 N/ mm ² and resistance to spread of flame of Class A category with property of being termite/borer proof, water/moisture proof and fire retardant and fixing with stainless steel screws etc. all as per direction of Engineer-InCharge 12 mm thick	62	SQM	1403.10	86992.2

Signature of Tenderer



18	Providing and Making of Storage cabinet and Students Table/ Conference Table as per the design/ drawing and instructions of Engineer Incharge fabricated withTermite Proof and BWP Plywood of centuryplywood/ Greenply/ Archid ply/ Kitply, covering up with Mica/ laminate of 1mm thickness of Century/ greenlam /Archid/ Surfica/Airolam, with Nails, fevicols etc complete including the hardware and fittings such as Handle, Telescopic hinges, Telescopic Channels etc. complete . Main Framing with 19/ 18mm and rest portion with thickness as per the design/ instructions of Architect/ Engineer in charge For design details drawing is attached. This includes making cutouts in the Table, buffer, fixing of the Electrical switch/ Socket, Desk Wire Cord Cable Grommets Hole Cover for Office PC Desk Cable Cord Organizer etc. Measurement of the Table / Cabinet will be taken in elevation i.e Length x Height only.	71	SQM	15000.00	1065000
19	Providing and laying in position specified grade of reinforced cement concrete, excluding the cost of centering, shuttering, finishing and reinforcement - All work up to plinth level				0
20	1:2:4 (1 cement : 2 coarse sand (zone-III) derived from natural sources : 4 graded stone aggregate 20 mm nominal size derived from natural sources)	2	CUM	7038.39	14076.78
21	12 mm cement plaster of mix : 1:6 (1 cement: 6 coarse sand)	10	SQM	281.79	2817.9
22	Steel reinforcement for R.C.C. work including straightening, cutting, bending, placing in position and binding all complete above plinth level. Thermo-Mechanically Treated bars of grade Fe-500D or more.	1	QTL	8843.70	8843.7
23	Providing and fixing false ceiling at all heights including providing and fixing of frame work made of special sections, power pressed from M.S. sheets and galvanized with zinc coating of 120 gms/sqm (both side inclusive) as per IS : 277 and consisting of angle cleats of size 25 mm wide x 1.6 mm thlck with flanges of 27 mm and 37mm, at 1200 mm centre to centre or As per the positioning/ desing requirement, one flange fixed to the ceiling with dash fastener 12.5 mm dia x 50 mm long with 6 mm dia bolts, other flange of cleat fixed to the angle hangers of 25x10x0.50 mm of required length with nuts & bolts of required size and other end of angle hanger fixed with intermediate G.I. channels 45x15x0.9 mm running at the spacing of 1200 mm centre to centre, to which the ceiling section 0.5 mm thick bottom wedge of 80 mm with tapered flanges of 26 mm each having lips of 10.5 mm, at 450 mm centre to centre, shall be fixed in a direction perpendicular to G.I. intermediate channel with connecting clips made out of 2.64 mm dia x 230 mm long G.I. wire at every junction, including fixing				0

Signature of Tenderer



24	perimeter channels 0.5 mm thick 27 mm high having flanges of 20 mm and 30 mm long, the perimeter of ceiling fixed to wall/partition with the help of rawl plugs at 450 mm centre, with 25 mm long dry wall screws @ 230 mm interval, including fixing of gypsum board to ceiling section and perimeter channel with the help of dry wall screws of size 3.5 x 25 mm at 230 mm c/c, including jointing and finishing to a flush finish of tapered and square edges of the board with recommended jointing compound , jointing tapes , finishing with jointing compound in 3 layers covering upto 150 mm on both sides of joint and two coats of primer suitable for board, all as per manufacturer's specification and also including the cost of making openings for light fittings, grills, diffusers, cutouts made with frame of perimeter channels suitably fixed, all complete as per drawings, specification and direction of the Engineer in Charge but excluding the cost of painting with : Framing to be as per the design requirement for fixing the board/ WPC. as per the grooves etc including cove making, making the cutouts for lights/ speakers/ any other equipment and making cutout for the projector trolley, A.C. indoor unit etc. including the peripheral framing as per the requirement around the cutout for fixing the A.C indoor unit etc. complete as per the instructions of Engineer Incharge.				0
25	12.5 mm thick tapered edge gypsum plain board conforming to IS:2095- (Par11):2011 (Board with BIS certification marks)	67	SQM	1111.76	74487.92
26	With 12 mm thick W.P.C./ Foam Plactis Board with proper screcs etc. in sizes as per the design/ drawing and instructed by the Engineer Incharge.	100	SQM	2291.79	229179
27	Making, Providing and fixing of Trap door of 600X600mm or above as per the design/ instructions in gypsum portion of false ceiling including cutting in the challen and additional support (if required) , proper frame peripheral, handle (as per requirement) etc. complete As per drawing/ Design/ instructions if engineer incharge.	1.44	SQM	2000.00	2880

Signature of Tenderer



28	Providing and laying Vittrified tiles in floor in different sizes (thickness to be specified by the manufacturer) with water absorption less than 0.08% and conforming to IS:15622, of approved brand & manufacturer, in all colours and shade, laid on 20 mm thick cement mortar 1:4 (1 cement: 4 coarse sand) jointing with grey cement slurry @3.3 kg/sqm including grouting the joints with white cement and matching pigments etc. The tiles must be cut with the zero chipping diamond cutter only . Laying of tiles will be done with the notch trowel, plier, wedge, clips of required thickness, leveling system and rubber mallet for placing the tiles gently and easily.Double charge vitrified tile polished finish of sizeSize of Tile 600 x 600 mm	257	SQM	1191.99	306341.43
29	Providing and laying Vittrified tiles in different sizes (thickness to be specified by manufacturer), with water absorption less than 0.08 % and conforming to I.S. 15622, of approved make, in all colours & shade, in skirting, riser of steps, over 12 mm thick bed of cement mortar 1:3 (1 cement: 3 coarse sand), jointing with grey cement slurry @ 3.3 kg/ sqm including grouting the joint with white cement & matching pigments etc. complete Size of Tile 600 x 600 mm	14	SQM	1330.90	18632.6
30	Providing & Fixing of wall paper as per Aproved Design, Thickness, texture/ finish etc. including pasting it with the suitable Adhesive properly complete as per design/ drawings and instructions of Engineer.	38	SQM	700.00	26600
31	Providing & Fixing of Roman/ Roller blinds on a window includes measuring the window dimensions accurately, selecting fabric with alternating sheer and opaque stripes, using durable aluminum or steel brackets for installation, ensuring smooth operation with a chain mechanism, and proper alignment for aesthetic and functional performance as per the instructions of Engineer Incharge.	40	SQM	2500.00	100000
32	Providing Concrete textured Planter of size 600x600x1000 with earth, sludge and manure mixed of aproved design shape etc. Plant will be finalized as per architect.	4	NOS	5000.00	20000
33	Supplying chemical emulsion in sealed containers including delivery as specified. Chlorpyrphos/ Lindane emulsifiable concentrate of 20%	150	LITRE	192.50	28875
34	Diluting and injecting chemical emulsion for POST-CONSTRUCTION anti-termite treatment (excluding the cost of chemical emulsion):				0
35	Treatment of soil under existing floors using chemical emulsion @ one litre per hole, 300 mm apart including drilling 12 mm diameter holes and plugging with cement mortar 1 :2 (1 cement : 2 Coarse sand) to match the existing floor: With Chlorpyrphos/Lindane E.C. 20% with 1% concentration	167	SQM	254.24	42458.08

Signature of Tenderer



36	Treatment of existing masonry using chemical emulsion @ one litre per hole at 300 mm interval including drilling holes at 45 degree and plugging them with cement mortar 1:2 (1 cement : 2 coarse sand) to the full depth of the hole : With Chlorpyrifos/Lindane E.C. 20% with 1% concentration	75	RMT	35.26	2644.5
37	Along the external wall below concrete or masonry apron using chemical emulsion @ 2.25 litres per linear metre including drilling and plugging holes etc.: With Chlorpyrifos/ Lindane E.C. 20% with 1% concentration	75	RMT	43.83	3287.25
38	Dismantling doors, windows and clerestory windows (steel or wood) shutter including chowkhats, architrave, holdfasts etc. complete and stacking within 50 metres lead : Of area 3 sq. metres and below	16	NOS	301.10	4817.6
39	Removal of existing pelmets from windows and doors	18	NOS	100.00	1800
40	Providing and fixing factory made uPVC glazed/wire mesh windows/ doors comprising of lead free uPVC multi-chambered frame, sash and mullion/coupler (where ever required) extruded profiles having minimum wall thickness of 1.70 mm for Series R1 and R2 profiles and 2.10 mm for Series R3 and R4 profiles conforming to EN: 12608 in any shape, colour and design duly reinforced with galvanized mild steel section made of required shape & size as per CPWD Specification, uPVC extruded glazing beads, interlocks and Inline sash adaptor (where ever required) of appropriate dimension, EPDM gasket, hardware, SS 304 grade fasteners of minimum 8 mm dia with countersunk head, comprising of matching polyamide PA6 grade sleeve for fixing frame to finished wall as per IS 1367 : Part 1 to 14, plastic packers, plastic caps and necessary stainless steel screws etc. Profile of frame, sash & mullion (if required) shall be mitred cut and fusion welded/mechanically jointed duly sealed at all corners, including drilling of holes for fixing hardware and drainage of water etc. After fixing frame the gap between frame and adjacent finished wall shall be filled with weather proof silicon sealant over backer rod of approved size and quality, all complete as per approved drawing conforming to CPWD specification & direction of Engineer-in-Charge. Section of steel reinforcement and cross sections of uPVC profiles to be as per design approved by Engineer-in-Charge. Wire mesh / Glazing of plain/ toughened/ laminated/ double glass unit with/ without high performance coatings as per design requirements and conforming to IS: 3548 & IS: 16231 shall be paid separately. Note:- Structural design proof checked from a Government Engineering Institute, to be provided by the manufacturer for (i) Sites with basic wind speed > 45 m/sec as per IS 875 - Part 3 (ii) Sites with structure height more than 20m for all wind speed				0

Signature of Tenderer



41	Two track four panels sliding windows with Aluminium channel for roller track, wool pile, zinc alloy (zamak) powder coated handle on three panels along with multi-point locking system, nylon rollers with SS 304 body.				0
42	Using R3 series with frame (55 mm & above) x (40 mm & above) & sash (30 mm & above) x (55 mm & above) (Height upto 1.8m).	25.6	SQM	6445.49	165004.544
43	Providing and fixing glazing in aluminium door, window, ventilator shutters and partitions etc. with EPDM rubber / neoprene gasket etc. complete as per the architectural drawings and the directions of engineer-in-charge . (Cost of aluminium snap beading shall be paid in basic item): With float glass panes of 5 mm thickness (weight not less than 12.50 kg/sqm)	25.6	SQM	1234.31	31598.336
44	Providing and fixing carbon steel galvanised (minimum coating 5 micron) dash fastener of 10 mm dia double threaded 6.8 grade (yield strength 480 N/mm ²), counter sunk head, comprising of 10 mm dia polyamide PA 6 grade sleeve, including drilling of hole in frame , concrete/ masonry, etc. as per direction of Engineer-in-charge. 10 x 80 mm	96.000	NOS	112.87	10835.52
45	Taking out existing wooden door shutter, repair by cutting, painting etc. and refixing of repaired door shutters to existing door frames, including replacement of hinges with screws, etc. as required, all complete as per the direction of the Engineer-in-charge.	2	NOS	351.86	703.72
46	Providing & Fixing decorative high pressure laminated sheet of plain / wood grain in gloss / matt/ suede finish with high density protective surface layer and reverse side of adhesive bonding quality conforming to IS : 2046 Type S, including cost of adhesive of approved quality. fixing to Door etc. 1.0 mm thick	174.81	SQM	735.79	128623.4499
47	Extra for providing lipping with 2nd class teak wood battens up to 25 mm depth width as per the door thickness on all edges of flush door shutters (over all area of door shutter to be measured).	12.850	SQM	379.13	4871.8205
48	Providing and fixing 2nd class teak wood lipping/ moulded beading or taj beading of size 18X5 mm/ of size as decided/ Approved of approved design fixed with wooden adhesive of approved quality and screws/nails on the edges of the Pre-laminated particle board as per direction of Engineer-in-charge.	11.46	RMT	83.76	959.8896
49	Making Cutout for Eye View in the Door	2	NOS	100.00	200
50	Providing and fixng 300 mm H type Fancy Handle of stainless Steel/ C.P. bbrass (design shap etc. as selected/approved) on the main entry door of toilet complete and making good any damage while fixing the handle cmplete to the satisfaction off engineer incharge.	4.000	NOS	759.32	3037.28

Signature of Tenderer



51	Providing and fixing bright finished brass/ Stainless Steel tower bolts (barrel type) as per the Approved design with necessary screws etc. complete :				0
52	250x10 mm	2	NOS	362.11	724.22
53	150x10 mm	2	NOS	235.55	471.1
54	Providing and fixing bright finished brass/ Stainless Steel single/ double hanging type floor door stopper as per the Approved design with necessary screws, etc. complete.	2	NOS	121.65	243.3
55	Providing wood work in frames of false ceiling, partitions etc. sawn and fixed in position with necessary stainless steel screws etc. Kiln seasoned and chemically treated hollock wood	4.62	CUM	58497.04	270256.3248
56	Motorized Projector Lift 12 Inch and Extended to 60 Inch. Material-Aluminium, Max Loading: 15kg, Plate Size: 50CM X 50CM, Motor:Synchronous Motor. Model and Make etc as Approved including the installation etc. complete. The Lift in Closed position should match with the level of ceiling.	3	NOS	22500.00	67500
57	Supplying and fixing the telephone Hand Set with Chorded as Well As Chordless handset both including connections with Telephone point with suitable wire, male female socket etc. complete. Beetel X78 Cordless Phone (Black) or equivalent	2	NOS	4299.00	8598
58	Providing and fixing aluminium extruded section body tubular type universal hydraulic door closer (having brand logo with ISI, IS : 3564, embossed on the body, door weight upto 36 kg to 80 kg and door width from 701 mm to 1000 mm), with double speed adjustment with necessary accessories and screws etc. complete.	2	NOS	806.18	1612.36
59	Providing and fixing Mild steel Race ways of suitable size galvanized/ powder coated on Floor/ on ceiling suspended with suitable support for pass over the cable bunch from podium/ Display to CP.U./ Projector	20.000	RMT	200.00	4000
60	12.41 Providing and fixing unplasticised Rigid PVC pipes for passing bunch of A.V. cables/ any other cable conforming to IS : 13592 Type A, including jointing with seal ring conforming to IS : 5382, leaving 10 mm gap for thermal expansion, (i) Single socketed pipes. Upto 75 mm diameter	10.010	RMT	204.02	2042.2402
61	<u>SUB-HEAD - I : INTERNAL WIRING</u>				0
62	Wiring for circuit/ submain wiring alongwith earth wire with the following sizes of FRLS PVC insulated copper conductor, single core cable in surface/ recessed medium class PVC conduit as required.				0
63	2 X 1.5 sq. mm + 1 X 1.5 sq. mm earth wire	365	Metre	233.00	85045
64	2 X 2.5 sq. mm + 1 X 2.5 sq. mm earth wire	50	Metre	275.00	13750
65	2 X 4 sq. mm + 1 X 4 sq. mm earth wire	80.000	Metre	334.00	26720

Signature of Tenderer



66	Supplying and fixing of following sizes of medium class PVC conduit along with accessories in surface/recess including cutting the wall and making good the same in case of recessed conduit as required.				0
67	25 mm	175	Metre	145.00	25375
68	32 mm	30	Metre	184.00	5520
69	40 mm	30	Metre	228.00	6840
70	Supply and fixing following sizes / Modules, GI Box along with modular base & cover plate for modular switch recess etc. as required as required.				0
71	1 or 2 module (75mmX75mm)	4	Nos	298.00	1192
72	3 module (100mmX75mm)	8	Nos	327.00	2616
73	6 Module (200mmX75mm)	30	Nos	402.00	12060
74	12 Module (200mmX150mm)	4.000	Nos	547.00	2188
75	Supplying and fixing following modular switch/ socket on the existing modular plate & switch box including connections but excluding modular plate etc. as required				0
76	5/6 A switch	90	Nos	103.00	9270
77	15/16 A switch	8	Nos	156.00	1248
78	3 Pin 5/6 A Socket outlet	70	Nos	122.00	8540
79	6 Pin 15/16 A Socket outlet	8	Nos	197.00	1576
80	Telephone socket outlet	2	No	148.00	296
81	Bell Push	2	No	140.00	280
82	Lan Socket	2	No	350.00	700
83	fan rod 700mm (approx)	12	No	450.00	5400
84	Supplying and fixing modular blanking plate on the existing modular plate & switch box excluding modular plate as required	20	No	40.00	800
85	Supplying & fixing suitable size GI box wih modular plate and cover in front on surface or in recess including providing and fixing 25 A modular socket outlet and 25 A modular SP MCB, "C" curve including connections, painting etc. as required.	8	No	727.00	5816
86	Installation ,Testing, Commissioning of wall bracket /ceiling fittings of all sizes and shapes containing upto two GLS/CFL/LED lamps per fitting, complete with all accessories including connections etc. as required.	50	Each	119.00	5950
87	Supply of Recessed mounting round 18W-20W, suitable for 24Hr Continuous Operation, 100lm/W, PF>0.95, THD <10% at full load, CRI>80, Avg Life Class 50000Hrs @L70, complete in all respect.	40.000	Each	577.50	23100

Signature of Tenderer



88	Surface Mount PHILIPS/ Havels/ as Approved 50-watt LED Batten/Tubelight StarBright Compact 4-ft Decorative Modern LED Wall/ ceiling Tubelight Cool Day Light. 10 lumens (for 50W) per watt., lifespan of 15,000 hours CCT of Luminaire 5700K with ANSI binning, CRI >80Ra. LED Used should have a life of 35000 hrs@L70. LM80 Report should be provided to verify life span of LED. LED Driver Should be Isolated type constant current APFC and have I/P voltage range of 150-270Volts, THD - <20%, PF - 0.95, Surge protection - 2KV, Driver Efficiency >85% and should have O/P Short Circuit protection, O/P open circuit protection, O/P over load protection. Product Should be BIS Approved. Reports Required - LM79/ LM80/ Photobiological Safety report	30	Each	851.95	25558.5
89	Supplying, Installation, connecting, testing and commissioning of Slider Fast Charger Wireless Electric Conference Table, Wireless Charger Compatible All Qi-Enabled Device Box with LAN Cat 5E Connector & 2 Power Socket 10 Amp & HDMI Port (Silver AVT-006)-Make Audiovan	2	Each	4500.00	9000
90	Supplying, installation, testing commissioning of Noise less BLDC ceiling fan 1200MM complete in all respect.	12	Each	7875.00	94500
91	SUBHEAD- III: DISTRIBUTION BOARD				0
92	Supplying and fixing following way, three pole and neutral, sheet steel, MCB distribution board, 415 volts, on surface/ recess complete with tinned copper busbar, neutral busbar, earth bar, din bar, detachable gland plate, interconnections, phosphatized and powder painted including earthing etc. as required. (But without MCB/ RCCB/ Isolator)				0
93	6 way (4 + 18), Double door	2	Each	4974.00	9948
94	8 way (4 + 24), Double door	2	Each	5967.00	11934
95	Supplying and fixing of following ways surface/ recess mounting, vertical type, 415 V, TPN MCB distribution board of sheet steel, dust protected, duly powder painted, inclusive of 200 A tinned copper bus bar, common neutral link, earth bar, din bar for mounting MCBs (but without MCBs and incomer) as required . (Note :Vertical type MCB TPDB is normally used where 3 phase outlets are required.)				0
96	4 way (4 + 12), Double door	1	Each	7512.00	7512
97	Supplying and fixing following rating, four pole, 415 V, MCB in the existing MCB DB complete with connections, testing and commissioning etc. as required				0
98	40 amps FP MCB	5	Each	1937.00	9685
99	100 amps FP MCB	1	Each	9704.00	9704

Signature of Tenderer



100	Supplying and fixing 5 amps to 32 amps rating, 240/415 volts, "C" curve, miniature circuit breaker suitable for inductive load of following poles in the existing MCB DB complete with connections, testing and commissioning etc. as required.				0
##	Single pole	20	Nos.	256.00	5120
##	Supplying and fixing single pole blanking plate in the existing MCB DB complete etc. as required.	8.000	Each	13.00	104
##	SUB-HEAD -IV- TELEPHONE & LAN SYSTEM				0
##	Supplying, drawing, connecting and testing of 0.5 mm dia annealed copper conductor PVC insulated PVC sheathed telephone wire in existing conduit/wire way duct etc. as required of following sizes:				0
##	2 Pair (4 core)	20	Metre	38.00	760
##	Supplying and fixing following modular switch/ socket on the existing modular plate & switch box including connections but excluding modular plate etc. as required				0
##	Telephone socket outlet	2	Each	148.00	296
##	TV antenna socket outlet	2	Each	148.00	296
##	RJ-45 Data Socket outlet	8.000	Each	626.00	5008
##	Supplying and drawing of UTP 4 pair CAT 6 LAN Cable in the existing surface/ recessed Steel/ PVC conduit as required.				0
##	1 run of cable	60	Metre	57.00	3420
##	Providing, laying, connecting and testing of unarmoured TV cable RG-6 PVC insulated cable along wall or ceiling or through existing pipe.	30	Metre	38.54	1156.2
##	SUB-HEAD -V : L.T. CABLES				0
##	Laying of one number PVC insulated and PVC sheathed / XLPE power cable of 1.1 KV grade of following size direct in ground including excavation and refilling the trench etc as required, but excluding sand cushioning and protective covering.				0
##	50 sq. mm to 95 Sq.mm	100	Meter	217.00	21700
##	Supply of following size of 1.1KV grade multicore aluminium conductor XLPE insulated and PVC sheathed armoured cable as per IS 7098:1988 with up to date amendment				0
##	4 x 50 sq.mm	100	Metre	250.00	25000
##	Supplying and making cable end terminations with brass compression gland and aluminium lugs for following size of PVC insulated PVC sheathed/XLPE aluminium conductor cable of 1.1 KV grade, complete as required.				0
##	4 X 50 sq. mm (35mm)	2	Each	418.00	836

Signature of Tenderer



##	Supplying and installing following size of perforated Hot Dipped Galvanised Iron cable tray (Galvanisation thickness not less than 50 microns) with perforation not more than 17.5%, in convenient sections, joined with connectors, suspended from the ceiling with G.I. suspenders including G.I. bolts & nuts, etc. as required.				0
##	100 mm wide x 50 mm depth x 1.6 mm thickness.	40	Meter	669.00	26760
##	Supplying and installing following size of perforated Hot Dipped Galvanised Iron cable tray "bends" (galvanisation not less than 50 microns) with perforation not more than 17.5%, in convenient sections, joined with connectors, suspended from the ceiling with G.I. suspenders including G.I. bolts & nuts, etc. as required.				0
##	100 mm wide x 50 mm depth x 1.6 mm thickness.	2	EACH	1159.00	2318
##	Supplying and installing following size of perforated Hot Dipped Galvanised Iron cable tray "Tee" (galvanisation not less than 50 microns) with perforation not more than 17.5%, in convenient sections, joined with connectors, suspended from the ceiling with G.I. suspenders including G.I. bolts & nuts, etc. as required.				0
##	100 mm wide x 50 mm depth x 1.6 mm thickness.	2	EACH	1327.00	2654
##	Supplying and installing following size of perforated Hot Dipped Galvanised Iron cable tray "Reducer" (galvanisation not less than 50 microns) with perforation not more than 17.5%, in convenient sections, joined with connectors, suspended from the ceiling with G.I. suspenders including G.I. bolts & nuts, etc. as required.				0
##	100 mm wide x 50 mm depth x 1.6 mm thickness.	2	EACH	1655.00	3310
##	GI Raceway & Junction boxes (Raceway on floor shall be of aluminium only)				0
##	Providing and fixing 2 mm thick steel sheet factory fabricated post galvanized raceway with internal partition/compartmentized of the following sizes including providing removable 3 mm thick GI cover, knock out holes and fixing accessories earthing with 8 SWG copper earth wire complete as required including floor supports, bends, access boxes, tap off boxes and cross over as per specification and site requirement. (overhead / wall mounted recovery & function boxes shall be 1.6 mm thick)				0
##	150 mm wide x 38 mm deep raceway	75	Meter	200.00	15000
##	Dismantling of lights, fixtures, fan, black board etc	50.65	EACH	75.00	3798.75
##	SUB-HEAD - VII: UPS				0

Signature of Tenderer



##	Supplying installation testing and commissioning of UPS-IN, 3000VA , 230V UPS System, High-Performance Premium Power Backup of 15 minutes & Protection for Home Office, etc. as required.with 8 nos. 7 Ah in built battery-Make Microtech	2	Nos	30130.00	60260
##	SUB HEAD-I: FIRE DETECTION AND ALARM SYSTEM				0
##	Supplying, installation, testing & commissioning of smoke detector with builtin LED and mounting base complete with all connections etc. as required.	4	Each	1153.00	4612
##	Supplying, installation, testing & commissioning of response indicator on surface/recessed MS Box having two LED, metallic cover complete with all connections etc as required.	2	Each	276.00	552
##	Supplying & laying of 2x1.5 sqmm fire alarm armoured cable , 600/1000V rated with annealed copper conductor having XLPE insulation, steel wire armouring & FRLS outer sheath complete as required.	32	Mtr	153.00	4896
##	Supplying, installation, testing & commissioning of addressable manual call point complete as required.	6	Pcs	438.00	2628
##	Air Conditioning System				0
##	Supply of Cassette type Hot and Cold Air Conditioning Units Indoor and Outdoor both of Approved Make. A.C. as per the OEM Design for Cooling Capacity of 10 HP (Around 8 tr). This included 4 Nos. indoor Casset unit and 2 nos out door units per classroom. In case VRF type A.C. is supplied then single Out door unit with of 10 HPfor each class can be supplied but in that case 50 % alternate circuit will go to different classrooms so that if one outdoor unit malfunctions, the airconditioning continues in the Classroom. The Compressor to be Inverter Type with Copper winding and Copper condensation coil etc. (preferred Make are Blue Star, Voltas, Mitsubishi Heavy, Career/ Toshiba, O-General/ As Approved)	2	Lot	#####	640000
##	Supply of Cabling, wiring, MCB, Remote, Wires, D.B., Control cable, Copper piping, Drain piping including Cable Tray etc. (for Carrying The Pippings and Cable), stand tie rod, suitable insulation as suggested by OEM Insulation of the Piping, Gas topup, NRV etc. and any other accessories/ item required to complete the commissioning of Airconditioning units and as per the Instructions of Engineer Incharge.Copper Pipe make/Thickness: Jobu/Rajco(0.8mm & 1 m.m.), Copper Pipe Insulation-A-flex(10mm), Drainage pipe : Supreme UPVC(Supreme 25/32 mm), Drainage insulation: 6 m.m. Nitrile sheet, Communication cable: Polycab(1.5mm 4 core)	2	Lot	45000.00	90000

Signature of Tenderer



##	Installation Testing and Commissioning of Casset A.C. for Both High end and low end side including complete Cabling, wiring, Copper piping, Drain piping including Cable Tray etc. (for Carrying The Pipings and Cable), including control Cables, MCB, stand, tie rod , Insulation of the Piping, Instalation testing and Commissinoing of indoor and out door units etc., NIitrogen testing of the Complete system, any other associted works required to complete so sas to properly commission the Airconditioning units and as per the Instructions of Engineer Incharge.	2	Lot	15000.00	30000
	Total in Figures				4832638.87

Signature of Tenderer

Drawings

PRODUCED BY AN AUTODESK STUDENT VERSION

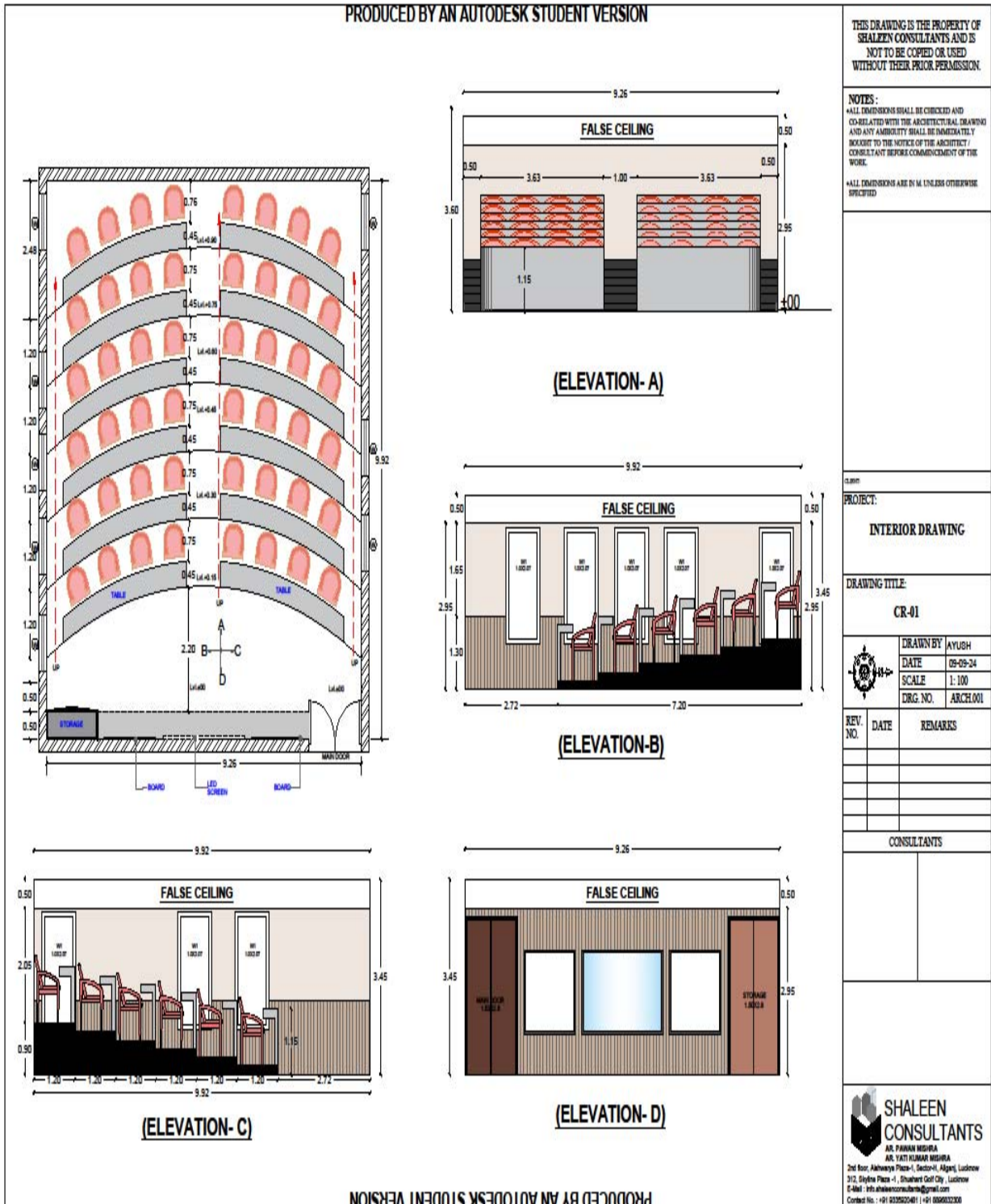

PRODUCED BY AN AUTODESK STUDENT VERSION

Signature of Tenderer

